

## 上海常浩高压管件有限公司

SHANGHAI CHANGHAO HIGH PRESSURE PIPE FITTINGS CO.,LTD.

销售地址：普陀区桃浦路321号 邮编：200333

工厂地址：浦东新区华夏东路3766号

电话：021-52851387 28600140 28211639

传真：021-33539683 51685120

网站：www.changhaopipe.com

All specification information is subject to change without notification.  
所有产品信息如有更改恕不另行通知。本公司保留对所述产品规格进行修改补充的权利。

## 上海常浩高压管件有限公司

SHANGHAI CHANGHAO HIGH PRESSURE PIPE FITTINGS CO.,LTD.



| 项目<br>类型        | 标准<br>Standard  | 规格<br>Size range | 性能等级<br>Property |
|-----------------|---|------------------|------------------|
| 六角螺母<br>Hex nut | GB41/6170/6175  | M12~M160         | 6~10             |
|                 | GB/T1229  | M12~M160         | 10H              |
|                 | HG20634/20613   | M12~M160         | 8, 10            |
|                 | SH3404-96   | M12~M160         | 6~10             |
|                 | ANSI/ASME B18.2.2   | 1/2"~4"          | SAE Gr. 5/8      |
|                 | ASTMA325/A490   | 1/2"~4"          | 8~10             |
|                 | DIN 934/2510  | M12~M160         | 6~10             |
|                 | DIN6915   | M12~M160         | 10H              |
|                 | ISO 4032  | M12~M160         | 6~10             |
| JIS1181         | M12~M160  | 6~10             |                  |
| 材料<br>Material  | 国内钢材：<br>碳钢 (Carbon Steel) :<br>Q345 (16Mn) ,25#,35#,45#<br>合结钢 (Alloy Steel) 20MnTiB,<br>35VB,40Cr,45MnMo, 30CrMoA,<br>35CrMoA,42CrMoA<br>25Cr2MoVA<br>不锈钢 (Stainless Steel)<br>0Cr18Ni9, 0Cr17Ni12Mo2,<br>00Cr19Ni10, 00Cr17Ni12Mo2<br>铁基合金 (Fe-Basic Alloy)<br>GH/T2132<br>镍基合金 (Ni-Basic Alloy)<br>GH/T2312, GH80A<br><br>国外钢材：<br>ASTM A307/A563<br>ASTM A193-B7/A194-2H (-7)<br>ASTM A193-B7M/A194-2HM<br>ASTM A193-B16/A194-4<br>ASTM A320-L7/A194-4 (-7)<br>ASTM A193-B8/A194-8 (LN)<br>ASTM A193-B8M/A194-8M (LN)<br>ASTM A453-Gr. 660<br>ASTM B637-UNS NO7080<br>AISI 304/316/304L/316L/321 |                  |                  |

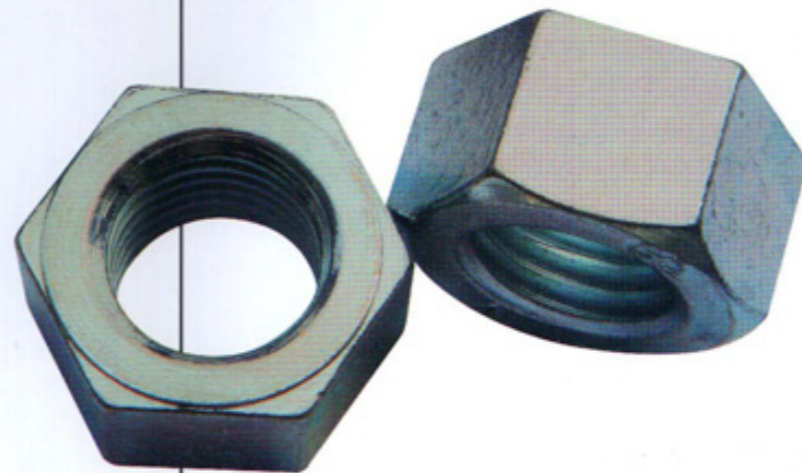
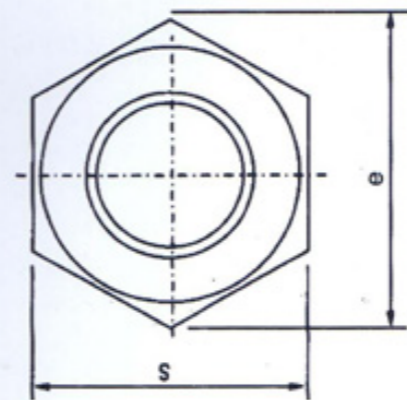
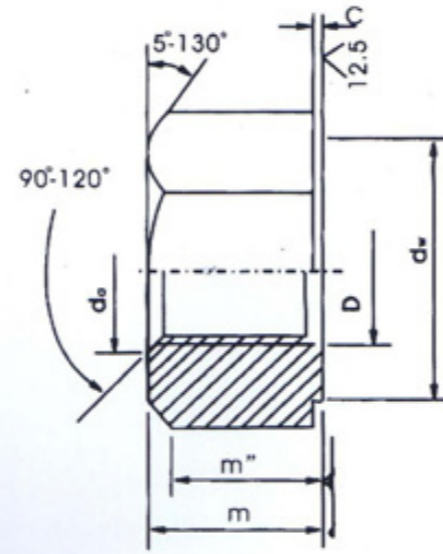

## 企业简介

### BRIEF INTRODUCTION



上海常浩高压管件有限公司是专业生产与销售高压管件的厂家,产品有锻造法兰、弯头、三通、异径管(大小头)、绝缘接头、绝缘法兰、锻制承插件和高压螺纹管件等各类管道配件。可按GB、HG、JB、SY、HGJ、SH、ASME、ANSI、API、MSS-SP、DIN、JIS等标准生产不同的管件和法兰。其产品除了在国内销售外,还远销东南亚、中东、欧洲、美洲、日本和韩国等国家和地区。产品优质,服务周到,在海内外赢得了很高的信誉,深受国内外广大客户的信赖,已成为国内较大的法兰和管件供应商之一。

公司建立了完善的产品质量管理体系,确保产品质量完全符合标准规范,满足客户要求。在产品的设计,材料采购、检验试验及生产的全过程中,严格执行管理体系文件规定。

本公司实力雄厚,公司拥有一批具有技术丰富的锻造实践和管道机械技术人才,配有完善的理化试验、机械性能、无损检测等一套先进的检测设备,为石油、化工、电力、冶金、造纸、制药等行业中的国内外大中型企业提供不同材质的工业管道配件和专业的配套服务。

上海常浩高压管件有限公司将以优质的产品、优惠的价格,完善的售后服务,竭诚满足用户要求,愿与海内外的朋友互惠互利、真诚合作、建立持久、相互信赖的合作关系,共创新世纪的辉煌。



Shanghai Chang-ho High Pressure Pipe Co., Ltd. is specialized in producing and marketing high-pressure pipe manufacturers, the products have forged flanges, elbows, three, different-diameter pipe (size head), insulation joints, insulating flange, and forging system for plug-ins Threaded pipe fittings and high pressure, such as various types of pipe fittings. Can be GB, HG, JB, SY, HGJ, SH, ASME, ANSI, API, MSS-SP, DIN, JIS standards for the production of different tube and flange. In addition to its products in domestic sales, but also Southeast Asia, the Middle East, Europe, the Americas, Japan and South Korea, and other countries and regions. Product quality, courteous service, at home and abroad won a high reputation, both at home and abroad by the trust our customers have become more domestic flange and pipe suppliers.

The company has established a perfect product quality management system to ensure the quality of products in full compliance with standard specifications to meet customer requirements. In the product design, material procurement, production test pilot and in the full and strict implementation of document management system requirements.

The strength of a solid company, the company has a number of technology is rich in forging machinery and pipe or technical personnel, with a sound physical and chemical testing, mechanical properties, such as a nondestructive testing of advanced testing equipment for the petroleum, chemical, power, metallurgy, paper, pharmaceutical, and other industries in the large and medium-sized enterprises at home and abroad to provide different materials of industrial pipe fittings and professional support services.

Shanghai Chang-ho High Pressure Pipe Co., will be quality products, pricing, and improve after-sales service and dedication to meet user requirements, and to friends at home and abroad and mutual benefit and sincere cooperation, the establishment of a lasting and mutually trust relationship between the total innovation century glory.



| 项目类型             | 标准 Standard       | 规格 Size range  | 性能等级 Property |  |
|------------------|-------------------|--|---------------|--|
| 六角螺栓<br>Hex bolt | GB5780-GB5783     | M12~M100   | 6.8~10.9      |  |
|                  | GB/T1228/1231     | M12~M100   | 10.9 S        |  |
|                  | GB/T3632          | M12~M100   | 10.9 S        |  |
|                  | HG20634/20613     | M12~M100   | 6.8~10.9      |  |
|                  | SH3404-96         | M12~M100   | 6.8~10.9      |  |
|                  | ANSI/ASME B18.2.1 | 1/2"~4"  | SAE Gr. 2/5/8 |  |
|                  | ASTMA325/A490     | 1/2"~4"  | 8.8~10.9      |  |
|                  | DIN 931/933       | M12~M100   | 6.8~10.9      |  |
|                  | DIN6914           | M12~M100   | 10.9 S        |  |
|                  | ISO4014/4017      | M12~M100   | 6.8~10.9      |  |
|                  | JIS1180           | M12~M100   | 6.8~10.9      |  |
|                  | 材料<br>Material    | 国内钢材:<br>碳钢 (Carbon Steel) :<br>Q345 (16Mn) ,25#,35#,45#<br>合金钢 (Alloy Steel) 20MnTiB,<br>35VB,40Cr,45MnMo, 30CrMoA,<br>35CrMoA,42CrMoA<br>25Cr2MoVA<br>不锈钢 (Stainless Steel)<br>0Cr18Ni9, 0Cr17Ni12Mo2,<br>00Cr19Ni10, 00Cr17Ni12Mo2<br>铁基合金 (Fe-Basic Alloy)<br>GH/T2132<br>镍基合金 (Ni-Basic Alloy)<br>GH/T2312, GH80A |               |  |
|                  |                   | 国外钢材:<br>ASTMA307/A563<br>ASTMA193-B7/A194-2H (-7)<br>ASTMA193-B7M/A194-2HM<br>ASTMA193-B16/A194-4<br>ASTMA320-L7/A194-4 (-7)<br>ASTMA193-B8/A194-8 (LN)<br>ASTMA193-B8M/A194-8M (LN)<br>ASTMA453-Gr. 660<br>ASTM B637-UNS NO7080<br>AISI 304/316/304L/316L/321  |               |  |

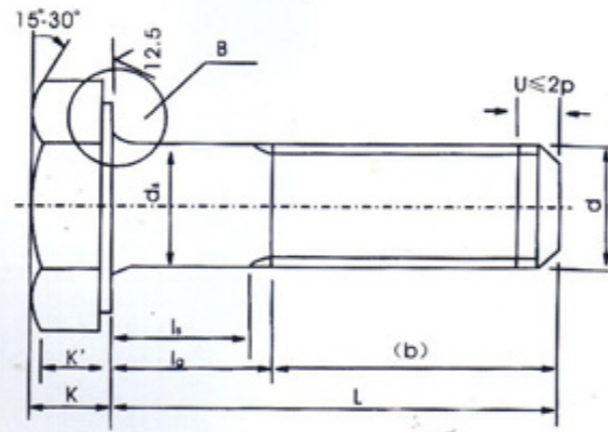

| 项目类型  | 标准 Standard       | 规格 Size range   | 性能等级 Property |
|---|-------------------|---|---------------|
| 双头(全丝)螺柱<br>Stud (full thread) bolt   | GB901/953         | M12~M160  | 6.8~10.9      |
|   | GB897/898/899     | M12~M160  | 6.8~10.9      |
|   | JB4707            | M12~M160  | 6.8~10.9      |
|   | HG20634/20613     | M12~M160  | 6.8~10.9      |
|   | HG/T21573         | M12~M160  | 6.8~10.9      |
|   | SH3404-96         | M12~M160  | 6.8~10.9      |
|   | ANSI/ASME B18.2.1 | 1/2"~4"   | SAE Gr. 5/8   |
|   | IFI-136           | 1/2"~4"   | SAE Gr. 5/8   |
|   | DIN975/976        | M12~M160  | 6.8~10.9      |
|   | DIN2510           | M12~M160  | 6.8~10.9      |
|   | BS 1769           | 1/2"~4"   | 6.8~10.9      |
|   | 材料<br>Material    | 国内钢材:<br>碳钢 (Carbon Steel) :<br>Q345B (16Mn) ,25#,35#,45#<br>合金钢 (Alloy Steel) 20MnTiB,<br>35VB,40Cr,45MnMo, 30CrMoA,<br>35CrMoA,42CrMoA<br>25Cr2MoVA<br>不锈钢 (Stainless Steel)<br>0Cr18Ni9, 0Cr17Ni12Mo2,<br>00Cr19Ni10, 00Cr17Ni12Mo2<br>铁基合金 (Fe-Basic Alloy)<br>GH/T2132<br>镍基合金 (Ni-Basic Alloy)<br>GH/T2312, GH80A |               |
| 国外钢材:<br>ASTMA307/A563<br>ASTMA193-B7/A194-2H (-7)<br>ASTMA193-B7M/A194-2HM<br>ASTMA193-B16/A194-4<br>ASTMA320-L7/A194-4 (-7)<br>ASTMA193-B8/A194-8 (LN)<br>ASTMA193-B8M/A194-8M (LN)<br>ASTMA453-Gr. 660<br>ASTM B637-UNS NO7080<br>AISI 304/316/304L/316L/321 |                   |   |               |

